



NOTTINGHAM WALL-MOUNT FAUCET SET

INSTALLATION INSTRUCTIONS

Before installing, read entire installation instructions. Observe all local building and safety codes.

Unpack and inspect the product for any shipping damages. If you find damages, do not install. Contact Customer Service at 1-866-855-2284. If you need assistance or have questions while installing your faucet set, contact Customer Service.

We recommend consulting a professional if you are unfamiliar with installing bathroom fixtures and plumbing. Signature Hardware accepts no liability for any damages to the floor, walls, plumbing or for personal injury during installation.

TOOLS AND MATERIALS:

Adjustable Wrench
Damp Cloth
Pipe Wrench

Basin Wrench
Pliers
Hacksaw

Plumber's Tape or Thread Sealant
Screwdrivers (Phillips and Flat Head)

WATER SUPPLY INSTALLATION

1. Slide the bell flanges (I) over the copper pipes at the finished floor.
2. Place thread sealant or plumber's tape on the copper pipes. Attach the straight stop valves (F) with the provided compression nuts (H) and ferrules (G).
3. Slide the remaining compression nuts (D) onto the supply tubes.
4. Place the supply tubes (C) and ferrules (E) into the straight stop valves and tighten the compression nuts.
5. Close the straight stop valves and briefly turn on the main water supply to check for leaks. If leakage occurs, tighten the connections with an adjustable wrench as necessary. If problems persist, contact Customer Service.
6. Install the tub faucet according to the **Faucet Installation** section.

PARTS LIST

- | | |
|---------------------------|----------------------------|
| A. (2) Rubber Cone Washer | F. (2) Straight Stop Valve |
| B. (2) Slip Nut | G. (2) Ferrule |
| C. (2) Supply Tube | H. (2) Compression Nut |
| D. (2) Compression Nut | I. (2) Bell Flange |
| E. (2) Ferrule | |

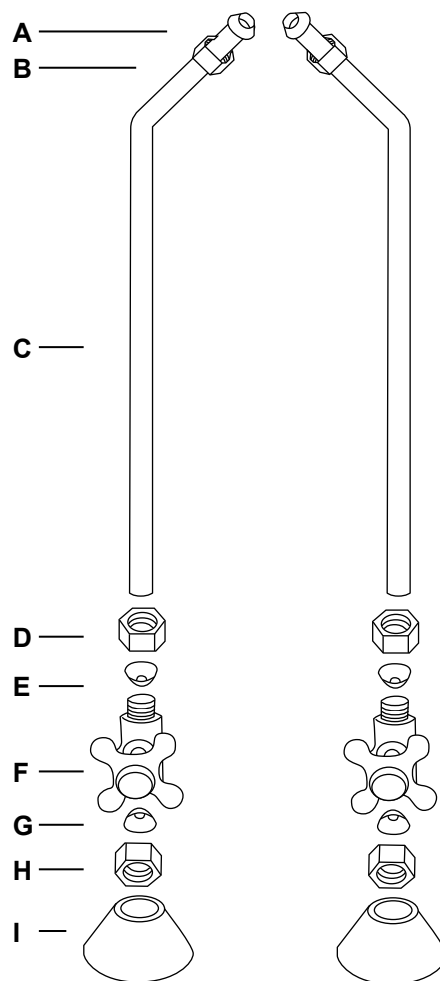



FAUCET INSTALLATION

1. Remove the threaded brass pipe nipple from the wall mount couplers.
2. Place thread sealant or plumber's tape on the 1/2" pipe nipples protruding from the wall.
3. Run a bead of silicone sealant along the base of the wall couplers.
4. Thread the wall couplers onto the 1/2" pipe nipples.
5. Make sure the bases of the couplers are firmly against the wall and that the couplers are aligned properly. Wipe away any excess sealant with a damp cloth.
6. Place the faucet body on the wall couplers. Hand tighten the coupling nuts to secure.
7. Install the hand shower and nozzle and any rubber sealing gaskets included.
8. When your faucet installation is complete, turn on the water supply. Check to make sure that all connections are tight (no water should be leaking) and that the hot and cold supplies are working correctly. Turn the water on and allow the water to flow through the spout for approximately 60 seconds.

INSTALLATION

Note: Because tubs vary in size, measure your space thoroughly before installation. Trim pipes accordingly to ensure a correct fit. Go to the **Trimming Drain Pipes** section for more information.

1. Apply thread sealant or plumber's tape to the threads at each end of all pipes prior to installation. If two pipes arrive attached, be sure to take them apart and apply sealant before installing.
2. Connect the tub shoe assembly (A), and rubber washer to the tub drain (B).
3. Install the overflow assembly (C) with the beveled washer, overflow plate, mounting screw (provided) and any other washers or rubber sealing gaskets included.
4. Attach the waste and overflow tee (D) to the overflow assembly (C) and shoe assembly (A) with sealing washers and slip nuts.
5. Attach the drain tube and flange (E) to the waste and overflow tee (D) with the sealing washer and slip nut.

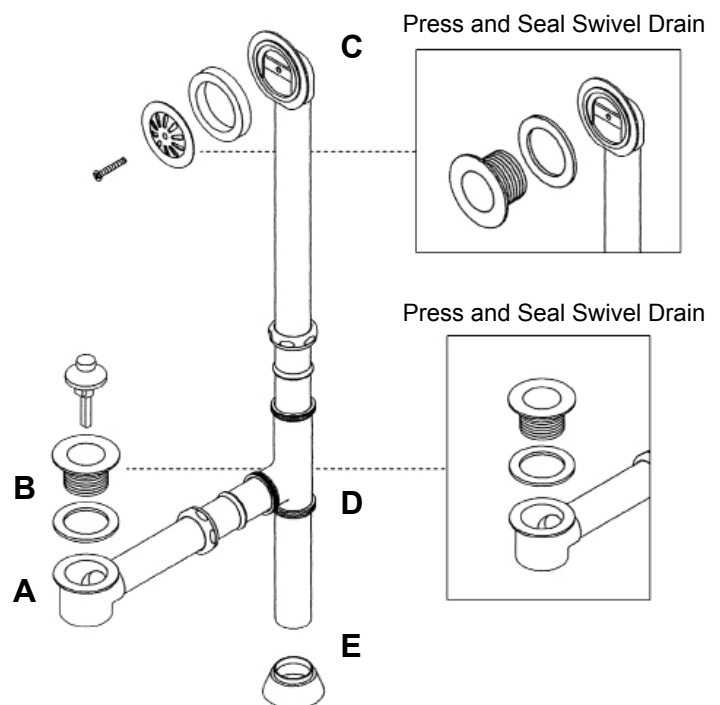



TRIMMING DRAIN PIPES

1. Connect the overflow and drain assemblies and pipes to the tub.
2. The T-connection will be attached at the points where the drain pipes intersect. Measure and mark each pipe so that the ends reach a little over halfway into the T-Connection hubs.
3. Trim the pipes as necessary with a hack saw with a blade that is suitable for cutting metal.

